

LEWIS
RIGGING MATERIAAL

LEWIS
RIGGING GEAR



Lewis hoogwaardige harpsluiting / moerbout
Lewis high tensile bow shackle / safety pin

| Gelijkend US Fed. Spec. RR-C-271

| Generally according to US Fed. Spec. RR-C-271

WLL = veilige belasting (6:1)
WLL = working load limit (6:1)

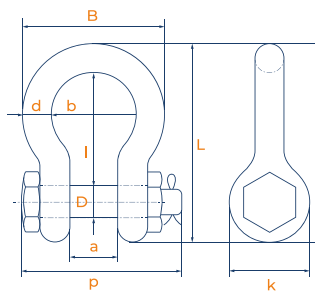

Artikelnr.	WLL	D	d	a	B	b	p	L	l	k	kg/stuk
Part no.	ton	mm	mm	mm	mm	mm	mm	mm	mm	mm	kg/piece
541020005	0,5	8	7	12	33	20	38	48	29	17	0,07
5410200075	0,75	10	9	13	38	21	43	54	31	21	0,13
54102001	1	11	10	17	46	26	52	65	36	25	0,17
541020015	1,5	12	11	18	51	29	58	74	43	27	0,25
54102002	2	16	13	21	58	32	67	83	48	30	0,44
5410200325	3,25	19	16	27	75	43	85	106	60	39	0,79
5410200475	4,75	22	19	32	89	50	100	125	71	47	1,26
541020065	6,5	25	22	38	102	58	120	148	84	53	1,9
541020085	8,5	28	25	44	118	68	137	165	95	59	2,8
541020095	9,5	32	29	49	132	74	155	188	108	68	3,9
54102012	12	35	32	51	147	83	163	208	121	75	5,3
541020135	13,5	38	35	57	162	92	180	230	132	82	6,95
54102017	17	42	38	63	174	98	193	246	145	91	8,85
54102025	25	50	45	74	216	126	220	298	178	104	15
54102035	35	56	52	84	252	145	250	338	197	122	19,5
54102055	55	70	67	107	318	180	310	443	260	145	39

Lewis hoogwaardige harpsluiting / borstbout
Lewis high tensile bow shackle / screw collar pin

| Gelijkend US Fed. Spec. RR-C-271
| Generally according to US Fed. Spec. RR-C-271

WLL = veilige belasting (6:1)
WLL = working load limit (6:1)

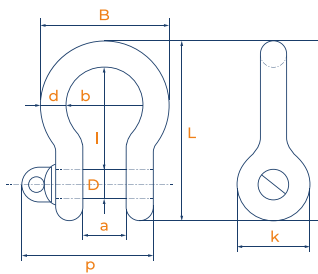

Artikelnr.	WLL	D	d	a	B	b	p	L	l	k	kg/stuk
Part no.	ton	mm	mm	mm	mm	mm	mm	mm	mm	mm	kg/piece
5410100033	0,33	6	5	10	26	15	30	38	22	15	0,02
541010005	0,5	8	7	12	33	20	38	48	29	17	0,07
5410100075	0,75	10	9	13	38	21	43	54	31	21	0,13
54101001	1	11	10	17	46	26	52	65	36	25	0,17
541010015	1,5	12	11	18	51	29	58	74	43	27	0,25
54101002	2	16	13	21	58	32	67	83	48	30	0,44
5410100325	3,25	19	16	27	75	43	85	106	60	39	0,79
5410100475	4,75	22	19	32	89	50	100	125	71	47	1,26
541010065	6,5	25	22	38	102	58	120	148	84	53	1,58
541010085	8,5	28	25	44	118	68	137	165	95	59	2,3
541010095	9,5	32	29	49	132	74	155	188	108	68	3,1
54101012	12	35	32	51	147	83	163	208	121	75	4,35

Lewis hoogwaardige D-sluiting / moerbout
Lewis high tensile dee shackle / safety pin

| Gelijkend US Fed. Spec. RR-C-271
| Generally according to US Fed. Spec. RR-C-271

WLL = veilige belasting (6:1)
WLL = working load limit (6:1)

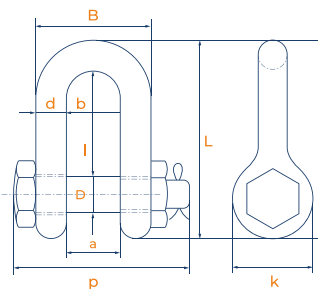

Artikelnr.	WLL	D	d	a	B	b	p	L	k	l	kg/stuk
Part no.	ton	mm	mm	mm	mm	mm	mm	mm	mm	mm	kg/piece
54202002	2	16	13	20	46	20	73	76	31	41	0,32
5420200325	3,25	19	17	26	59	26	94	97	40	50	0,63

Lewis hoogwaardige D-sluiting / borstbout
Lewis high tensile dee shackle / screw collar pin

| Gelijkend US Fed. Spec. RR-C-271
| Generally according to US Fed. Spec. RR-C-271

WLL = veilige belasting (6:1)
WLL = working load limit (6:1)

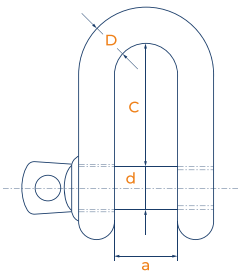

Artikelnr.	WLL	D	d	a	C	kg/stuk
Part no.	ton	mm	mm	mm	mm	kg/piece
5420100075	0,75	8	9	12	25	0,08
54201001	1	10	11	15	31	0,13
542010015	1,5	12	13	18	36	0,19
54201002	2	13	16	20	40	0,30
5420100325	3,25	17	19	25	51	0,59

Lewis hoogwaardige harpsluiting / moerbout / zwart
Lewis high tensile bow shackle / safety pin / black

| Gelijkend US Fed. Spec. RR-C-271
| Generally according to US Fed. Spec. RR-C-271

WLL = veilige belasting (6:1)
WLL = working load limit (6:1)

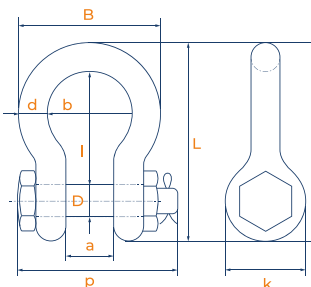

Artikelnr.	WLL	D	d	a	B	b	p	L	I	k	kg/stuk
Part no.	ton	mm	mm	mm	mm	mm	mm	mm	mm	mm	kg/piece
5410600325	3,25	19	16	27	75	43	85	106	60	39	0,79

Lewis hoogwaardige harpsluiting / borstbout / zwart
Lewis high tensile bow shackle / screw pin / black

| Gelijkend US Fed. Spec. RR-C-271

| Generally according to US Fed. Spec. RR-C-271

WLL = veilige belasting (6:1)
WLL = working load limit (6:1)

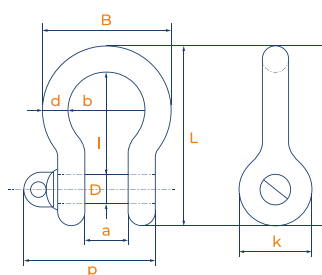

Artikelnr.	WLL	D	d	a	B	b	p	L	I	k	kg/stuk
Part no.	ton	mm	mm	mm	mm	mm	mm	mm	mm	mm	kg/piece
541040005	0,5	8	7	12	33	20	38	48	29	17	0,07
5410400075	0,75	10	9	13	38	21	43	54	31	21	0,13
54104001	1	11	10	17	46	26	52	65	36	25	0,17
541040015	1,5	12	11	18	51	29	58	74	43	27	0,25
54104002	2	16	13	21	58	32	67	83	48	30	0,44
5410400325	3,25	19	16	27	75	43	85	106	60	39	0,79

Lewis hoogwaardig stalen spanschroef / oog-oog
Lewis high tensile rigging screw / eye-eye

| Gelijkend US Fed. Spec. FF-T-791b
| Generally according to US Fed. Spec. FF-T-791b

WLL = veilige belasting (5:1)
WLL = working load limit (5:1)

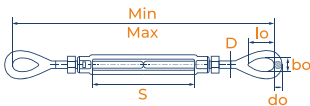

Artikelnr.	S	WLL	D	do	lo	bo	Min	Max	kg/stuk
Part no.	inch	ton	inch	mm	mm	mm	mm	mm	kg/piece
561010X06	6	0,55	3/8	9	28	13	290	440	0,34
561012X06	6	1	1/2	12	36	18	330	480	0,64
561012X09	9	1	1/2	12	36	18	405	630	0,76
561012X12	12	1	1/2	12	36	18	482	782	0,96
561016X06	6	1,6	5/8	14	44	22	375	525	1,18
561016X09	9	1,6	5/8	14	44	22	450	675	1,38
561016X12	12	1,6	5/8	14	44	22	526	826	1,76
561020X06	6	2,36	3/4	17	52	25	415	565	1,80
561020X09	9	2,36	3/4	17	52	25	490	715	2,17
561020X12	12	2,36	3/4	17	52	25	560	860	2,44
561020X18	18	2,36	3/4	17	52	25	720	1170	2,44
561022X12	12	3,27	7/8	20	59	31	592	885	3,38
561022X18	18	3,27	7/8	20	59	31	750	1200	4,42
561025X06	6	4,54	1	22	75	37	517	668	4,05
561025X12	12	4,54	1	22	75	37	656	943	5,25
561025X18	18	4,54	1	22	75	37	819	1269	6,25

Lewis hoogwaardig stalen spanschroef / gaffel-gaffel
Lewis high tensile rigging screw / jaw-jaw

| Gelijkend US Fed. Spec. FF-T-791b

| Generally according to US Fed. Spec. FF-T-791b

WLL = veilige belasting (5:1)
WLL = working load limit (5:1)

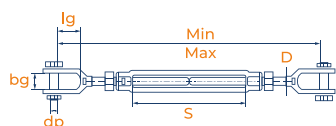

Artikelnr.	S	WLL	D	bg	Min	Max	lg	dp	kg/stuk
Part no.	inch	ton	inch	mm	mm	mm	mm	mm	kg/piece
563010X06	6	0,55	3/8	13	270	420	23	8	0,38
563012X06	6	1	1/2	17	305	455	30	9	0,71
563012X09	9	1	1/2	17	375	600	30	9	0,82
563012X12	12	1	1/2	17	450	750	30	9	0,98
563016X06	6	1,6	5/8	19	340	490	34	12	1,18
563016X09	9	1,6	5/8	19	425	650	34	12	1,44
563016X12	12	1,6	5/8	19	490	790	34	12	1,75
563020X06	6	2,36	3/4	23	375	525	41	15	1,78
563020X09	9	2,36	3/4	23	450	675	41	15	2,12
563020X12	12	2,36	3/4	23	530	830	41	15	2,59
563020X18	18	2,36	3/4	23	680	1130	41	15	3,25
563022X12	12	3,27	7/8	27	560	860	46	19	3,52
563022X18	18	3,27	7/8	27	715	1165	46	19	4,58
563025X06	6	4,54	1	30	445	595	54	22	4,18
563025X12	12	4,54	1	30	595	895	54	22	5,49
563025X18	18	4,54	1	30	760	1210	54	22	6,44
563032X12	12	6,90	1 1/4	44	668	962	77	28	10,34
563032X18	18	6,90	1 1/4	44	796	1248	77	28	12,31
563038X12	12	9,71	1 1/2	53	684	986	76	35	16,10
563038X24	24	9,71	1 1/2	53	1005	1600	76	35	21,59
563045X24	24	12,70	1 3/4	60	1051	1650	90	42	29,03
563050X24	24	16,80	2	69	1210	1820	120	50	42,75

Lewis hoogwaardig stalen spanschroef / gaffel-oog
Lewis high tensile rigging screw / jaw-eye

| Gelijkend US Fed. Spec. FF-T-791b

| Generally according to US Fed. Spec. FF-T-791b

WLL = veilige belasting (5:1)
WLL = working load limit (5:1)

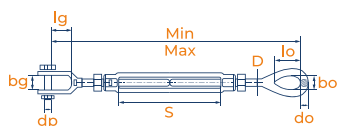

Artikelnr.	S	WLL	D	do	lo	bg	bo	Min	Max	lg	dp	kg/stuk
Part no.	inch	ton	inch	mm	mm	mm	mm	mm	mm	mm	mm	kg/piece
562010X06	6	0,55	3/8	9	28	13	13	279	429	23	8	0,36
562012X06	6	1	1/2	12	36	17	18	315	465	30	9	0,72
562012X09	9	1	1/2	12	36	17	18	390	615	30	9	0,84
562012X12	12	1	1/2	12	36	17	18	465	765	30	9	1,02
562016X06	6	1,6	5/8	14	44	19	22	360	510	34	12	1,2
562016X09	9	1,6	5/8	14	44	19	22	430	655	34	12	1,48
562016X12	12	1,6	5/8	14	44	19	22	515	815	34	12	1,76
562020X06	6	2,36	3/4	17	52	23	25	390	540	41	15	1,88
562020X09	9	2,36	3/4	17	52	23	25	460	685	41	15	2,25
562020X12	12	2,36	3/4	17	52	23	25	540	840	41	15	2,60
562020X18	18	2,36	3/4	17	52	23	25	695	1145	41	15	3,29
562022X12	12	3,27	7/8	20	59	27	31	570	870	46	19	3,56
562022X18	18	3,27	7/8	20	59	27	31	725	1175	46	19	4,62
562025X06	6	4,54	1	22	75	30	37	465	615	54	22	4,15
562025X12	12	4,54	1	22	75	30	37	620	920	54	22	5,31
562025X18	18	4,54	1	22	75	30	37	770	1220	54	22	6,35