

LEWIS  
HIJSMATERIAAL G80

LEWIS  
LIFTING GEAR G80



**Lewis hijsketting / G80 / zwart gelakt**  
**Lewis lifting chain / G80 / black painted**

| EN 818-2

| EN 818-2



DK = diameter ketting  
DK = diameter chain

WLL = veilige belasting (4:1)  
WLL = working load limit (4:1)

LC = lashing capaciteit  
LC = lashing capacity

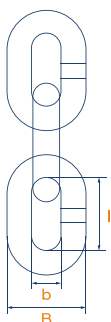

Artikelnr.	DK	B	b	l	WLL	LC	kg/100m
Part no.	mm	mm	mm	mm	kg	kg	kg/100m
50101006	6	22,2	7,8	18	1.120	2.240	80
50101007	7	25,9	9,1	21	1.500	3.000	110
50101008	8	29,6	10,4	24	2.000	4.000	140
50101010	10	37,0	13,0	30	3.150	6.300	220
50101013	13	48,1	16,9	39	5.300	10.600	380
50101016	16	59,2	20,8	48	8.000	16.000	570
50101020	20	74,0	26,0	60	12.500	25.000	870
50101022	22	81,4	28,6	66	15.000	30.000	1.040
50101026	26	96,2	33,8	78	21.200	42.400	1.470
50101032	32	118,0	41,6	96	31.500	63.000	2.240

**Lewis hijsketting / G80 / verzinkt**  
**Lewis lifting chain / G80 / electro galvanised**

| EN 818-2

| EN 818-2



DK = diameter ketting  
DK = diameter chain

WLL = veilige belasting (4:1)  
WLL = working load limit (4:1)

LC = lashing capaciteit  
LC = lashing capacity



Artikelnr.	DK	B	b	l	WLL	LC	kg/100m
Part no.	mm	mm	mm	mm	kg	kg	kg/100m
50102006	6	22,2	7,8	18	1.120	2.240	80
50102007	7	25,9	9,1	21	1.500	3.000	110
50102008	8	29,6	10,4	24	2.000	4.000	140
50102010	10	37,0	13,0	30	3.150	6.300	220
50102013	13	48,1	16,9	39	5.300	10.600	380
50102016	16	59,2	20,8	48	8.000	16.000	570

**Lewis takelketting / G80 / verzinkt**

| EN 818-7

**Lewis hoist chain / G80 / electro galvanised**

| EN 818-7



WLL = veilige belasting (4:1)  
WLL = working load limit (4:1)

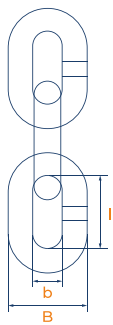

Artikelnr.	D	B	b	l	WLL	kg/100m
Part no.	mm	mm	mm	mm	kg	kg/100m
489090500412	4	13,2	5,2	12,0	500	36
489090500618	6	19,8	7,8	18,0	1.150	80
48909050063191	6,3	22,0	7,8	19,1	1.300	86
489090500721	7	23,1	8,7	21,0	1.500	108
4890905007212	7,1	25,0	8,8	21,2	1.600	108
489090500824	8	27,2	9,6	24,0	2.000	149
489090500927	9	29,7	11,5	27,0	2.500	185
489090501030	10	34,0	12,0	30,0	3.200	219
489090550618	6 (zwart) / 6 (black)	20,4	7,2	18,0	1.150	80

**Lewis verbindingschalm / G80**

| EN 1677-1

**Lewis connecting link / G80**

| EN 1677-1



DK = diameter ketting  
DK = diameter chain

WLL = veilige belasting (4:1)  
WLL = working load limit (4:1)

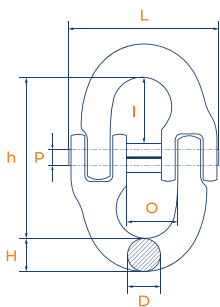

Artikelnr.	Type	DK	D	PxL	H	h	l	O	WLL	kg/stuk
Part no.		mm	mm	mm	mm	mm	mm	mm	kg	kg/piece
50301006	L-VS-6	6	7	4,8 x 39,6	7,3	42	15	17	1.120	0,1
50301008	L-VS-7/8	7/8	9	6 x 53,5	9,5	57	22,5	20	2.000	0,16
50301010	L-VS-10	10	10,6	7,8 x 66,8	12,4	68	25,2	28	3.150	0,3
50301013	L-VS-13	13	15	10 x 80	15,3	85,2	29,8	29	5.300	0,7
50301016	L-VS-16	16	20,3	12 x 100	20,6	104	39,8	36,3	8.000	1,15
50301020	L-VS-20	20	23	15 x 118	24	117	44	41	12.500	2,1
50301022	L-VS-22	22	27,3	17 x 145	27,3	138	53	49,5	15.000	2,87
50301026	L-VS-26	26	31,3	20 x 170	31	157	60	57,5	21.200	4,5
50301032	L-VS-32	32	39	24 x 210	39	205	78	67,5	31.500	8,21

**Lewis verbindingsschalm / hijsbanden / G80**  
**Lewis connecting link for webbing / G80**

| EN 1677-1  
| EN 1677-1



DK = diameter ketting  
DK = diameter chain

WLL = veilige belasting (4:1)  
WLL = working load limit (4:1)

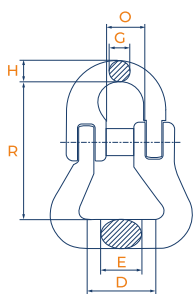

Artikelnr.	Type	DK	D	R	E	G	H	O	WLL	kg/stuk
Part no.		mm	mm	mm	mm	mm	mm	mm	kg	kg/piece
50302006	L-VH-6	6	38	56	18	7	7,5	15,5	1.120	0,2
50302008	L-VH-7/8	7/8	38	64	24	8,5	9	20	2.000	0,3
50302010	L-VH-10	10	45	86	30,5	11	12	24	3.150	0,53
50302013	L-VH-13	13	51	94	36,8	16,5	16,5	28,5	5.300	1,03

**Lewis topschalm / 1/2-sprong / G80**  
**Lewis masterlink / 1/2 legs / G80**

| EN 1677-4  
| EN 1677-4



DK-1 = diameter ketting bij kettingleng  
DK-1 = diameter chain 1-leg

DK-2 = diameter ketting bij 2-sprong  
DK-2 = diameter chain 2-legs

WLL = veilige belasting (4:1)  
WLL = working load limit (4:1)

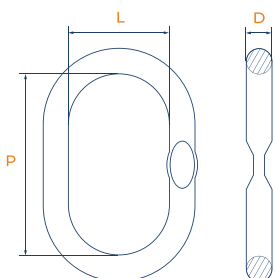

Artikelnr.	Type	DK-1	DK-2	D	L	P	WLL	kg/stuk
Part no.		mm	mm	mm	mm	mm	kg	kg/piece
50341007	L-76-8	6/7	6	13	60	110	1.600	0,34
50341008	L-87-8	8	7	16	60	110	2.120	0,54
50341010	L-108-8	10	8	18	75	135	3.150	0,82
50341013	L-1310-8	13	10	22	90	160	5.300	1,5
50341016	L-1613-8	16	13	26	100	180	8.000	2,3
50341018	L-1816-8	18	16	32	110	200	11.200	3,95

**Lewis topschalm / 3/4-sprong / G80**  
**Lewis masterlink / 3/4 legs / G80**

| EN 1677-4

| EN 1677-4

DK = diameter ketting  
DK = diameter chain

WLL = veilige belasting (4:1)  
WLL = working load limit (4:1)

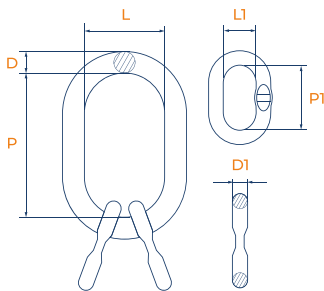

Artikelnr.	Type	DK	D	D1	L	L1	P	P1	WLL	kg/stuk
Part no.		mm	mm	mm	mm	mm	mm	mm	kg	kg/piece
50342007	L-7-8	6/7	18	13	75	38	135	50	3.150	1,24
50342008	L-8-8	8	22	16	90	34	160	70	4.250	2,20
50342010	L-10-8	10	26	18	100	40	180	85	6.700	3,40
50342013	L-13-8	13	32	22	110	50	200	115	11.200	6,10
50342016	L-16-8	16	36	26	140	65	260	140	17.000	9,98

**Lewis ooghaak / gesmede veiligheidsklep / G80**  
**Lewis eye sling hook / forged safety latch / G80**

| EN 1677-2

| EN 1677-2

DK = diameter ketting  
DK = diameter chain

WLL = veilige belasting (4:1)  
WLL = working load limit (4:1)

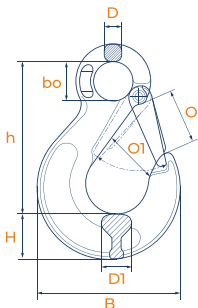

Artikelnr.	Type	DK	D	D1	B	H	h	O	O1	bo	WLL	kg/stuk
Part no.		mm	mm	mm	mm	mm	mm	mm	mm	mm	kg	kg/piece
50402006	L-OH-6	6	10	17	68	22	78	25	19	19,8	1.120	0,3
50402008	L-OH-7/8	7/8	11,5	18,5	83	30	93	28	22	24,5	2.000	0,5
50402010	L-OH-10	10	14,5	24	103	35	117	35	29	33,5	3.150	0,95
50402013	L-OH-13	13	17,5	29	132	40	150	43	35	42	5.300	1,6
50402016	L-OH-16	16	22	35,5	156,5	54	182	51	43	52	8.000	3,1

**Lewis gaffelhaak / gesmede veiligheidsklep / G80**  
**Lewis clevis sling hook / forged safety latch / G80**

| EN 1677-2  
| EN 1677-2



DK = diameter ketting  
DK = diameter chain

WLL = veilige belasting (4:1)  
WLL = working load limit (4:1)

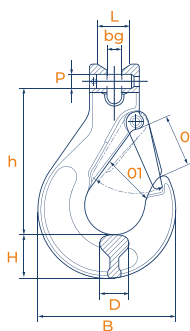

Artikelnr.	Type	DK	D	PxL	B	bg	H	h	O	O1	WLL	kg/stuk
Part no.		mm	mm	mm	mm	mm	mm	mm	mm	mm	kg	kg/piece
50401006	L-GH-6	6	15	7,7 x 17	68	6,8	22	70	25	19	1.120	0,25
50401008	L-GH-7/8	7/8	19	9 x 23,2	87,4	9	27,8	85	30,5	24	2.000	0,55
50401010	L-GH-10	10	25	12,5 x 29,6	106,7	12,3	34	107	37,8	30	3.150	1,2
50401013	L-GH-13	13	29,7	16 x 38,9	130	14,3	42	132	48,6	38	5.300	2,1
50401016	L-GH-16	16	38	19,7 x 48,8	155,5	17,2	49	153	54	44	8.000	3,3

**Lewis self-locking haak / gaffel / G80**  
**Lewis clevis self-locking hook / G80**

| EN 1677-3  
| EN 1677-3



DK = diameter ketting  
DK = diameter chain

WLL = veilige belasting (4:1)  
WLL = working load limit (4:1)

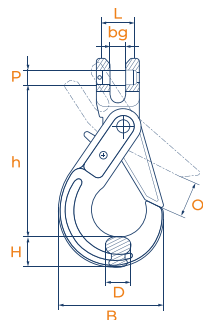

Artikelnr.	Type	DK	D	PxL	B	bg	H	h	O	WLL	kg/stuk
Part no.		mm	mm	mm	mm	mm	mm	mm	mm	kg	kg/piece
50601006	L-SG-6	6	15	7,6x22,2	70	7	21	97	30	1.120	0,5
50601008	L-SG-7/8	7/8	19	8,9x26,6	89	9	28	115	40	2.000	0,8
50601010	L-SG-10	10	26	13x32,8	108	12	29	141	51	3.150	1,5
50601013	L-SG-13	13	32	16x41,3	137	14,8	43	177	68	5.300	2,8
50601016	L-SG-16	16	38	20x52,6	170	17,2	51	205	77	8.000	5,6

**Lewis wartelhaak / klep / gelagerd / G80**  
**Lewis swivel hook / safety latch / bearing / G80**

| EN 1677-2  
| EN 1677-2



DK = diameter ketting  
DK = diameter chain

WLL = veilige belasting (4:1)  
WLL = working load limit (4:1)

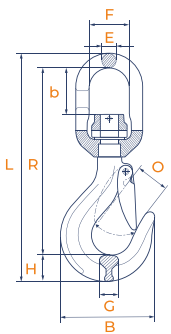

Artikelnr.	Type	DK	B	b	R	E	F	G	H	L	O	WLL	kg/stuk
Part no.		mm	mm	mm	mm	mm	mm	mm	mm	mm	mm	kg	kg/piece
50404006	L-WK-6	6	72	29	136	11	33	16	20	166	25	1.120	0,65
50404008	L-WK-7/8	7/8	88	42	165	14	36	21	25	205	26	2.000	0,95
50404010	L-WK-10	10	105	50	204	17	42	23	31	252	31	3.150	1,71
50404013	L-WK-13	13	135	58	242	19	50	32	40	296	38	5.300	2,97
50404016	L-WK-16	16	160	62	280	24	60	38	45	357	43	8.000	5,3
50404020	L-WK-18/20	18/20	191	90	356	25	74	49	50	434	56	12.500	9,5

**Lewis inkortklaauw / gaffel / G80**  
**Lewis clevis shortening clutch / G80**

| EN 1677-1  
| EN 1677-1



DK = diameter ketting  
DK = diameter chain

WLL = veilige belasting (4:1)  
WLL = working load limit (4:1)

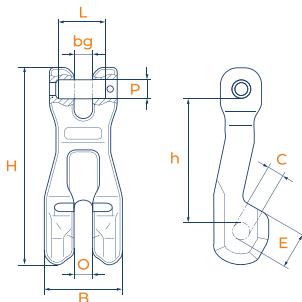

Artikelnr.	Type	DK	PxL	B	bg	C	E	H	h	O	WLL	kg/stuk
Part no.		mm	mm	mm	mm	mm	mm	mm	mm	mm	kg	kg/piece
50503006	L-KG-6	6	7,5x16,8	33	7	7	12	73	48	7	1.120	0,25
50503008	L-KG-7/8	7/8	9x24	45	9	9	17	101	66	9	2.000	0,41
50503010	L-KG-10	10	13x32	55	12,8	12	28	137	89	12,8	3.150	0,98
50503013	L-KG-13	13	16,1x41	75	17	14,8	34	177	116	17	5.300	2

**Lewis inkortklauw / gaffel / beveiliging / G80**

| EN 1677-1

**Lewis clevis shortening clutch / safety pawl / G80**

| EN 1677-1



DK = diameter ketting  
DK = diameter chain

WLL = veilige belasting (4:1)  
WLL = working load limit (4:1)

Artikelnr.	Type	DK	PxL	B	bg	C	E	H	h	O	WLL	kg/stuk
Part no.		mm	mm	mm	mm	mm	mm	mm	mm	mm	kg	kg/piece
50503406	L-KV-6	6	7,5x16,8	40	8	7,5	12	91	54	8,5	1.120	0,6
50503408	L-KV-8	8	9x24	46,5	9,5	11	17	109	69	9,5	2.000	0,90

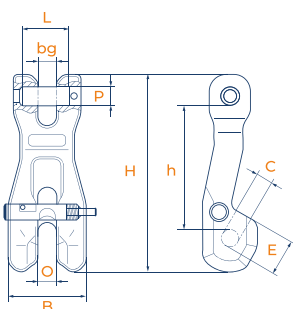

**Lewis inkorthaak / gaffel / G80**

| EN 1677-1

**Lewis clevis grab hook / G80**

| EN 1677-1



DK = diameter ketting  
DK = diameter chain

WLL = veilige belasting (4:1)  
WLL = working load limit (4:1)

Artikelnr.	Type	DK	D	PxL	B	bg	H	h	O	WLL	kg/stuk
Part no.		mm	mm	mm	mm	mm	mm	mm	mm	kg	kg/piece
50501006	L-IG-6	6	22	7,6x22	46	7	19	44,7	7,8	1.120	0,25
50501008	L-IG-7/8	7/8	32	9x25,3	50	9	20	51,8	10,4	2.000	0,32
50501010	L-IG-10	10	44	12,5x31	71,5	12	30	74	12,5	3.150	0,73
50501013	L-IG-13	13	58	16x38,9	94,5	14,8	43	89	15	5.300	1,6
50501016	L-IG-16	16	66	19,7x41	114	19	46	112	19,2	8.000	2,8

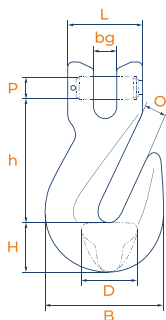



**Lewis inkorthaak / gaffel / uitvalbeveiliging / G80**  
**Lewis clevis grab hook / safety device / G80**

| EN 1677-1  
| EN 1677-1



DK = diameter ketting  
DK = diameter chain

WLL = veilige belasting (4:1)  
WLL = working load limit (4:1)

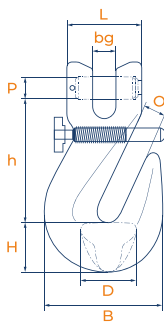

Artikelnr.	Type	DK	D	PxL	B	bg	H	h	O	WLL	kg/stuk
Part no.		mm	mm	mm	mm	mm	mm	mm	mm	kg	kg/piece
50501406	L-IV-6	6	22	7,6x22	46	7	19	44,7	7,8	1.120	0,25
50501408	L-IV-7/8	7/8	32	9x25,3	50	9	20	51,8	10,4	2.000	0,32
50501410	L-IV-10	10	44	12,5x31	71,5	12	30	74	12,5	3.150	0,73
50501413	L-IV-13	13	58	16x38,9	94,5	14,8	43	89	15	5.300	1,6
50501416	L-IV-16	16	66	19,7x41	114	19	46	112	19,2	8.000	2,8

**Lewis inkorthaak / oog / beveiliging / G80**  
**Lewis eye grab hook / safety device / G80**

| EN 1677-1  
| EN 1677-1



DK = diameter ketting  
DK = diameter chain

WLL = veilige belasting (4:1)  
WLL = working load limit (4:1)

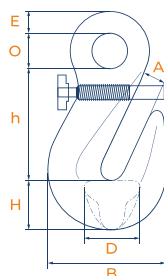

Artikelnr.	Type	DK	A	D	B	E	H	h	O	WLL	kg/stuk
Part no.		mm	mm	mm	mm	mm	mm	mm	mm	kg	kg/piece
50502408	L-IOV-7/8	7/8	10,4	31	50	11	23	43	15	2.000	0,35
50502410	L-IOV-10	10	12,5	40	65	12	30	52	22	3.150	0,60
50502413	L-IOV-13	13	15	50	85	16	37	65	26	5.300	1,3

**Lewis ketting-kabel verbinder / G80**  
**Lewis chain-ropo connector / G80**

| EN 1677-1  
| EN 1677-1



DK = diameter ketting  
DK = diameter chain

LC = lashing capaciteit  
LC = lashing capacity

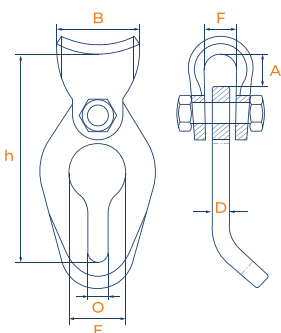

Artikelnr.	Type	DK	A	D	B	E	F	h	O	LC	kg/stuk
Part no.		mm	mm	mm	mm	mm	mm	mm	mm	kg	kg/piece
50701008	L-KK-7/8	7/8	20	10,5	49	33,5	20	123	11,5	4.000	0,65
50701010	L-KK-10	10	21,5	10,6	57	40	24	139	13	6.300	0,89

**Lewis C-haak / gaffel / G80**  
**Lewis clevis C-hooks / G80**

| EN 1677-2  
| EN 1677-2



DK = diameter ketting  
DK = diameter chain

LC = lashing capaciteit  
LC = lashing capacity

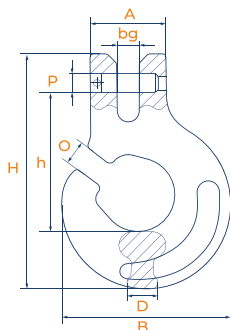

Artikelnr.	Type	DK	A	D	B	bg	H	h	O	P	LC	kg/stuk
Part no.		mm	mm	mm	mm	mm	mm	mm	mm	mm	kg	kg/piece
50721008	L-CH-7/8	7/8	35	18	72,7	9,5	95,5	59	9,8	9	4.000	0,37
50721010	L-CH-10	10	44	22	97	13	137	74	13	11,8	6.300	0,90

**Lewis glijhaak / G80**

| EN 1677-2

**Lewis glijding choker hook / G80**

| EN 1677-2



WLL = veilige belasting (4:1)  
WLL = working load limit (4:1)

Artikelnr.	Type	A	D	B	E	L	WLL	kg/stuk
Part no.		mm	mm	mm	mm	mm	kg	kg/piece
50740016	L-G-1.6T	50	17	71	18	132	1.600	0,68
50740020	L-G-2.0T	63,5	22	79	20	151,3	2.000	1,21

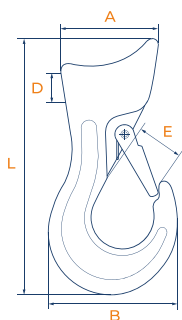

**Lewis aanlashaak / G80**

**Lewis weld-on hook / G80**



WLL = veilige belasting (4:1)  
WLL = working load limit (4:1)

Artikelnr.	Type	B	C	H	L	M	O	WLL	kg/stuk
Part no.		mm	mm	mm	mm	mm	mm	kg	kg/piece
50741001	L-AH-6	25	59,5	76	97	19	25	1.120	0,48
50741002	L-AH-8	34	67	92	114	23,3	26,5	2.000	0,85
50741003	L-AH-10	36	75	106	129	33,6	30,5	3.000	1,12
50741005	L-AH-13	45	94	136	171	44	34,5	5.000	2,50
50741008	L-AH-16	51	94	140	177	44	34,5	8.000	3,2
50741010	L-AH-18	53	135	175	223	54,7	51	10.000	5,2

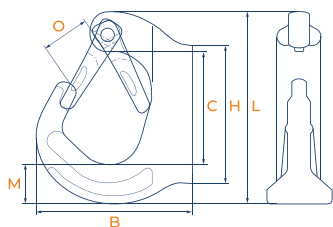

**Lewis hoogwaardig stalen S-haak / gesloten / G80**  
**Lewis high tensile S-hook / closed / G80**



WLL = veilige belasting (4:1)  
WLL = working load limit (4:1)

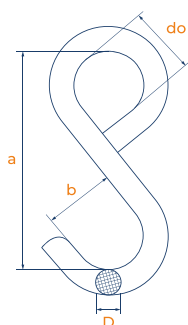

Artikelnr.	D	a	b	do	WLL	kg/stuk
Part no.	mm	mm	mm	mm	kg	kg/piece
39352010	10	80	25	25	200	0,10
39352013	13	100	30	30	300	0,20
39352016	16	130	40	40	500	0,50
39352020	20	180	55	55	1000	1,0

**Lewis hoogwaardig stalen S-haak / open / G80**  
**Lewis high tensile S-hook / open / G80**



WLL = veilige belasting (4:1)  
WLL = working load limit (4:1)

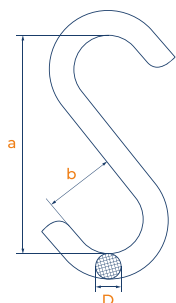

Artikelnr.	D	a	b	WLL	kg/stuk
Part no.	mm	mm	mm	kg	kg/piece
39351810	10	80	25	200	0,10
39351813	13	100	30	300	0,20
39351816	16	130	40	500	0,50
39351820	20	180	55	1000	1,00

**Lewis palset voor self-locking haak / G80/100**

**Lewis locking device for self-locking hook / G80/100**

| Inhoud set: pal, veer en stift

| Set contains: locking devise, spring and pin

DK = diameter ketting  
DK = diameter chain



Artikelnr.	Type	Voor type	DK	kg/stuk
Part no.		For type	mm	kg/piece
50953006	L-PS-6	L-SG-6 / L-SGC-6	6	0,03
50953008	L-PS-7/8	L-SG-7/8 / L-SGC-7/8	7/8	0,04
50953010	L-PS-10	L-SG-10 / L-SGC-10	10	0,06
50953013	L-PS-13	L-SG-13 / L-SGC-13	13	0,10
50953016	L-PS-16	L-SG-16 / L-SGC-16	16	0,14

**Lewis reserveset voor verbindingsschalm / G80**

**Lewis spare set for connecting link / G80**

| Inhoud set: pin en bus

| Set contains: pin and bush

DK = diameter ketting  
DK = diameter chain



Artikelnr.	Type	Voor type	DK	kg/stuk
Part no.		For type	mm	kg/piece
50952006	L-PB-6	L-VS-6	6	0,03
50952008	L-PB-7/8	L-VS-7/8	7/8	0,035
50952010	L-PB-10	L-VS-10	10	0,06
50952013	L-PB-13	L-VS-13	13	0,1
50952016	L-PB-16	L-VS-16	16	0,135

**Lewis gesmede klepset voor gaffel- of ooghaak / G80**  
**Lewis forged latch set for sling hook / G80**

| Inhoud set: klep, veer en stift  
| Set contains: latch, spring and pin



DK = diameter ketting  
DK = diameter chain

Artikelnr.	Type	Voor type	DK	kg/stuk
Part no.		For type	mm	kg/piece
50951006	L-KS-6	L-GH-6 & L-OH-6	6	0,03
50951008	L-KS-7/8	L-GH-7/8 & L-OH-7/8	7/8	0,035
50951010	L-KS-10	L-GH-10 & L-OH-10	10	0,06
50951013	L-KS-13	L-GH-13 & L-OH-13	13	0,1
50951016	L-KS-16	L-GH-16 & L-OH-16	16	0,135



**Identificatieplaatje / G80**  
**Identification tag / G80**



Artikelnr.	Type	Voor type	kg/stuk
Part no.		For type	kg/piece
50955010	zonder ring / without ring	leng / 1 leg	0,12
50955020	zonder ring / without ring	2-3-4 sprong / 2-3-4 legs	0,12
50955030	met ring / with ring	leng / 1 leg	0,15
50955040	met ring / with ring	2-3-4 sprong / 2-3-4 legs	0,15
50955050	losse ring / ring only		0,03



**Lewis gesmede klepset voor Lewis aanlashaak / G80**  
**Lewis forged latch set for Lewis weld-on hook / G80**

| Inhoud set: klep, veer en stiften  
| Set contains: latch, spring and pins



Artikelnr.	Type	Voor type	kg/stuk
Part no.		For type	kg/piece
50951401	L-KA-6	L-AH-6	0,04
50951402	L-KA-8	L-AH-8	0,09
50951403	L-KA-10	L-AH-10	0,14
50951405	L-KA-13	L-AH-13	0,33
50951408	L-KA-16	L-AH-16	0,33
50951410	L-KA-18	L-AH-18	0,56

**Lewis borgpenset voor Lewis inkorthaak / G80**  
**Lewis safety device set for Lewis grab hook / G80**

| Inhoud set: pin, veer en borgdop  
| Set contains: pin, spring and button



DK = diameter ketting  
DK = diameter chain

Artikelnr.	Type	Voor type	DK	kg/stuk
Part no.		For type	mm	kg/piece
50954006	L-BG-6	L-IV-6	6	0,01
50954008	L-BG-7/8	L-IV-7/8	7/8	0,02
50954010	L-BG-10	L-IV-10	10	0,025
50954013	L-BG-13	L-IV-13	13	0,03
50954016	L-BG-16	L-IV-16	16	0,04